

D Condo-Onnuch Suvarnabhumi

NARACONSULT & DESIGN CO.,LTD.

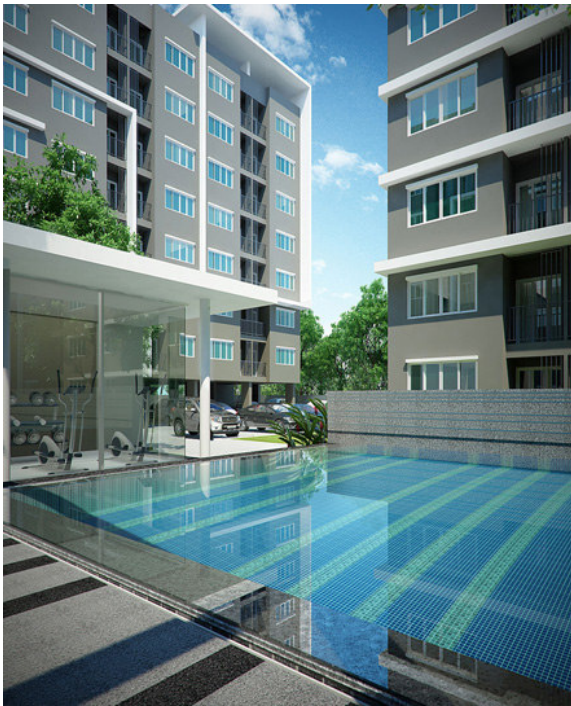

Location

Onnuch - Ladkrabang Rd., Ladkrabang, Bangkok

Owner

Plus Property Co., Ltd.

Budget

Baht 436 millions

Type of Building

Condominium

4 Buildings 8 Storey

Total 916 Units

Scope of Services

- Tendering of Contracts
- Quantity Surveying & Cost Estimate
- Cost Management
- Contracts Administration
- Schedule Control
- Site Inspection
- Evaluate of Progress & Payment Certificate
- Progress Report
- Contract Closeout
- Warranty Period

Interior View



CONSTRUCTION MANAGEMENT

Address 23/47 Floor 2-4 Soi Soomwajai, Rama 9 Road, Kwang Bangkok, Khet Huaykwang, Bangkok 10310 Thailand
http://www.naraconsult.com Tel. 02-641-4700-1

NARA
consult